

PRODUCT DATASHEET

SMART+ TIBEA Pendant

TIBEA CEILING E27 | Indoor luminaires, E27 socket



AREAS OF APPLICATION

- General illumination
- Living areas (living rooms, dining rooms, bedrooms etc.)
- Professional (hotels, bars, boutiques etc.)
- Suitable for lamps with E27 base

PRODUCT BENEFITS

- Stylish and modern design
- Easy to install and use
- High flexibility in the choice of the light source thanks to E27 base

PRODUCT FEATURES

- Retro design
- As ceiling, pendant and mini type-version available



TECHNICAL DATA

Electrical data

Nominal voltage	220...240 V
Nominal current	NaN A
Mains frequency	50/60 Hz

Dimensions & weight

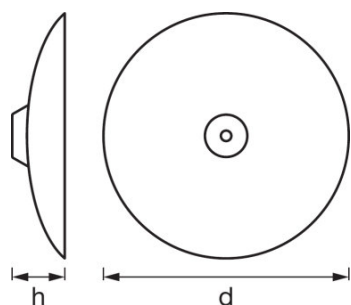

Product weight	600.00 g
Height	69.0 mm
Diameter	350.0 mm

Colors & materials

Product color	White
Body material	Aluminum
Housing color	White

Temperatures & operating conditions

Ambient temperature range	-20...+40 °C
---------------------------	--------------

Capabilities

Holder designation	E27
Dimmable	No
Type of connection	Terminal, 2-Pole (L, N)

Certificates & standards

Standards	CE
Protection class	II
Type of protection	IP20
Energy clas. of compatible lamps	A++/A+/A/B/C/D/E

EQUIPMENT / ACCESSORIES

– TIBEA style lamps can be combined with these luminaires

LOGISTICAL DATA

Product code	Packaging unit (Pieces/Unit)	Dimensions (length x width x height)	Gross weight	Volume
4058075168695	Folding carton box 1	361 mm x 465 mm x 109 mm	1048.00 g	18.30 dm ³
4058075168701	Shipping carton box 2	570 mm x 460 mm x 230 mm	3772.00 g	60.31 dm ³

The mentioned product code describes the smallest quantity unit which can be ordered. One shipping unit can contain one or more single products. When placing an order, for the quantity please enter single or multiples of a shipping unit.

DISCLAIMER

Subject to change without notice. Errors and omission excepted. Always make sure to use the most recent release.