

# PRODUCT DATASHEET

## SMART+ TIBEA Ceiling

TIBEA CEILING E27 | Indoor luminaires, E27 socket



---

### AREAS OF APPLICATION

- General illumination
- Living areas (living rooms, dining rooms, bedrooms etc.)
- Professional (hotels, bars, boutiques etc.)
- Suitable for lamps with E27 base

---

### PRODUCT BENEFITS

- Stylish and modern design
- Easy to install and use
- High flexibility in the choice of the light source thanks to E27 base

---

### PRODUCT FEATURES

- Retro design
- As ceiling, pendant and mini type-version available



## TECHNICAL DATA

### Electrical data

|                 |             |
|-----------------|-------------|
| Nominal voltage | 220...240 V |
| Nominal current | NaN A       |
| Mains frequency | 50/60 Hz    |

### Photometrical data

|                           |   |
|---------------------------|---|
| Light color (designation) | - |
|---------------------------|---|

### Dimensions & weight

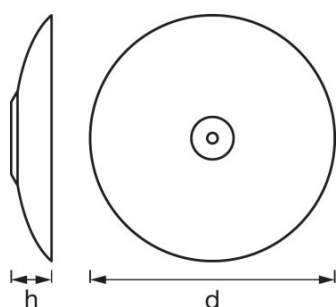

|                |          |
|----------------|----------|
| Product weight | 950.00 g |
| Height         | 51.0 mm  |
| Diameter       | 500.0 mm |

### Colors & materials

|               |          |
|---------------|----------|
| Product color | White    |
| Body material | Aluminum |
| Housing color | White    |

### Temperatures & operating conditions

|                           |              |
|---------------------------|--------------|
| Ambient temperature range | -20...+40 °C |
|---------------------------|--------------|

### Capabilities

|                    |                         |
|--------------------|-------------------------|
| Holder designation | E27                     |
| Dimmable           | No                      |
| Type of connection | Terminal, 2-Pole (L, N) |

### Certificates & standards

|                  |    |
|------------------|----|
| Standards        | CE |
| Protection class | II |

|                                  |                  |
|----------------------------------|------------------|
| Type of protection               | IP20             |
| Energy clas. of compatible lamps | A++/A+/A/B/C/D/E |

## EQUIPMENT / ACCESSORIES

– TIBEA style lamps can be combined with these luminaires

## LOGISTICAL DATA

| Product code  | Packaging unit (Pieces/Unit) | Dimensions (length x width x height) | Gross weight | Volume                |
|---------------|------------------------------|--------------------------------------|--------------|-----------------------|
| 4058075168633 | Folding carton box<br>1      | 529 mm x 664 mm x 79 mm              | 1786.00 g    | 27.75 dm <sup>3</sup> |
| 4058075168640 | Shipping carton box<br>2     | 750 mm x 610 mm x 172 mm             | 5259.00 g    | 78.69 dm <sup>3</sup> |

The mentioned product code describes the smallest quantity unit which can be ordered. One shipping unit can contain one or more single products. When placing an order, for the quantity please enter single or multiples of a shipping unit.

## DISCLAIMER

Subject to change without notice. Errors and omission excepted. Always make sure to use the most recent release.